



ActivPanel

INTERACTIVE FLAT PANELS

55", 65", 75" and 84"

DESCRIPTION

Introducing the ActivPanel, the next generation interactive flat panel with Full HD and 4K Ultra HD displays designed to enhance the classroom viewing experience and interaction amongst students.

AT A GLANCE

BRILLIANT PICTURE QUALITY



Available in Full HD or 4K Ultra HD displays that ensure the entire class has an optimal viewing experience.

ENGAGING LESSONS



Create and deliver interactive lessons and assessments with our award-winning software, ClassFlow and ActivInspire. ActivInspire Professional Edition license is included in your ActivPanel purchase.

SEAMLESS TEACHING & LEARNING EXPERIENCE



Our external Wi-Fi-enabled Android™ device, included with the ActivPanel, enables wireless mirroring of mobile devices onto the ActivPanel. Instantly you can download and use your favorite apps from any Android App Store, launch the Instant Whiteboard to write or draw, and wirelessly share lesson content.

INSTANT COLLABORATION & INTERACTIVITY



Multi-user interactivity with 10 simultaneous touch points and 1 digital pen. Our ActivGlide Technology™ delivers smooth interactivity at the touch of a finger.

BEST-IN-CLASS CONNECTIVITY



Offers a variety of ports for convenient peripheral connectivity, including 4 HDMI ports, 4 USB touch, 2 OPS slots, VGA, Audio, Source Switched USB HUB and more.

MOVE FREELY THROUGHOUT THE CLASSROOM



Easily connect mobile devices using the dual network capability. Teachers can take advantage of the wireless mirroring to share their content from anywhere in the room.

INTELLIGENT DESIGN



Innovation in computing power doubles every 2 years. We will ensure that you have the latest and greatest by offering an upgradeable solution that allows you to replace your existing Promethean Android device with the most up-to-date technology.

DEPENDABLE



The ActivPanel is built to last and offers a Five-Year On-Site Support Warranty.

GENERAL SPECIFICATIONS

INTERACTIVITY

Compatibility	Windows 7 to 10 Mac OS X 10.6 - 10.11 Linux Ubuntu 12.04 -14.04 Chromebook with touch
Continuous Touch Points	10
Digital Pen	1
Gestures and Edge Swipes	Win 8.1 Optimised & MacBook
USB HID Pen & Touch Compatible	Yes
Touch Technology	Infrared
Touch Resolution	Up to 32,768 x 32,768
Bezel Size	26mm
Positioning Accuracy	<2mm
Tracking Rate	> 200"/sec
First Touch Response	6 ms
Subsequent Touch	3 ms
Response Scan Speed	6 ms

DISPLAY

Glass Type	4mm acid-etched tempered glass
Glass Hardness	7 Mohs
Anti-Reflection, Glare & Friction Technology	ActivGlide™ Surface Technology
Panel Grade	Commercial Grade A
Screen Type	TFT LCD
Lighting Design	Direct LED Backlight
Aspect Ratio	16:9
Pixel Response Time	As low as 5 ms
Refresh Rate	HD 60 Hz, UHD 120 Hz
Viewing Angle	178°
Backlight Life Time	Up to 50,000 hours

GENERAL SPECIFICATIONS

AUDIO

Speakers	Dual downward facing speakers
Power	2 x 20 Watts

CONNECTIVITY

Inputs

HDMI 2.0	x 4
USB Touch	x 4
VGA (D-Sub) via Dongle	x 1
DP ++ via Dongle	x 1
PC Audio (3.5mm)	x 2
USB 3.0 (HD Media)	x 2
OPS Slots	x 2
RS232 Serial	x 1

Outputs

HDMI 2.0	x 1 (Switches with Source)
SPDIF Digital Audio	x 1
Headphone	x 1
RS232 Serial	x 1
USB Pass Through Ports	x 2

EXTERNAL ANDROID

System Version	Android 5.1 Lollipop
CPU	Rockchip RK3368 Octa Core up to 1.5GHz
GPU	SGX6110; support 4K*2K H.265/H.264/2GB
	2GB DDR3
RAM	2GB
Internal Storage	16GB

POWER CONSUMPTION

Standby Mode	<0.5W
Power Consumption	Backlight after 5 mins and ActivPanel
Auto Standby Mode	standby after 60 mins

ENVIRONMENTAL

Operating Temperature	5°C to 40°C (41°F to 104°F)
Storage Temperature	2°C to 55°C (36°F to 131°F)
Operating Humidity	20% to 80% humidity
Storage Humidity	10% to 90% humidity

DIGITAL PEN

Pen Function	HID pen digitiser or mouse Independent and non-concurrent of touch
Left Click	Mechanical tip switch
Right Click	Barrel button
Hover	Yes
Battery	AAA non-rechargeable
Battery Life	>1 year
Pen Storage	Pen holder attached to ActivPanel to protect pen and preserve battery life

PACKED CONTENTS

ActivPanel	x 1
Digital Pen	x 1
Stylus	x 2
Wall Mount	x 1
VESA Mount Bolts	x 4
Remote Control	x 1
Batteries	x 3 AAA
Power Cable	x 1 (3m UK, US, EU, AUS)
HDMI Cable + Fastener	x 1 (3m / 9.8ft)
USB Cable + Fastener	x 1 (3m / 9.8ft)
VGA Cable + Fastener	x 1 (3m / 9.8ft)
3.5mm Audio Cable	x 1 (3m / 9.8ft)
Installation Guide	x 1
User Guide	x 1

COMPLIANCE

& CERTIFICATION

Regulatory Certification	UL/CUL, FCC, IC, CE, CB, CCC, RCM
--------------------------	-----------------------------------

WARRANTY

Standard Warranty	Five-Year On-Site Support Warranty (subject to registration)
-------------------	--

INSTALLATION

The ActivPanel includes a fixed wall mount system. The installation of this product should be completed by a Trained Promethean Installer. Use of components not supplied by Promethean or not meeting minimum specifications may impact performance, safety and warranty. For more information, visit Support.PrometheanWorld.com

SUPPORT

For online support for all Promethean Products, please visit: Support.PrometheanWorld.com

STAND OPTIONS

Fixed Wall Mount: Included in box
Non-Adjustable Mobile Stand: Available in all markets
Adjustable Wall Mount, Tilt Frame Wall Mount & Mobile Stand: Available in specific markets

TECHNICAL SPECIFICATIONS BASED ON SIZE

DISPLAY						
Diagonal Size	55" HD	65" HD	75" HD	65" 4K UHD	75" 4K UHD	84" 4K UHD
Brightness	350 cd/m ²	350 cd/m ²	400 cd/m ²	450 cd/m ²	450 cd/m ²	350 cd/m ²
Contrast Ratio	1400:1	1400:1	5000:1	1200:1	5000:1	1600:1
Display Colours	16.7m (8-bit)	16.7m (8-bit)	16.7m (8-bit)	1.07B (10-bit)	1.07B (10-bit)	1.06B (10-bit)
Optimum Resolution	Full HD 1080p 1920 x 1080 @ 60Hz	Full HD 1080p 1920 x 1080 @ 60Hz	Full HD 1080p 1920 x 1080 @ 60Hz	4K UHD 2160p 3840 x 2160 @ 60Hz	4K UHD 2160p 3840 x 2160 @ 60Hz	4K UHD 2160p 3840 x 2160 @ 60Hz
Display Area	1210mm x 680mm (47.6" x 26.7")	1428mm x 803mm (56.2" x 31.6")	1650mm x 928mm (65" x 36.5")	1428mm x 803mm (56.2" x 31.6")	1650mm x 928mm (65" x 36.5")	1867mm x 1053mm (73.5" x 41.5")
INTERACTIVITY						
Output rate	111Hz	111Hz	90Hz	111Hz	90Hz	83Hz
PHYSICAL						
Overall Dimensions	1291.7mm x 762.5mm x 89.3mm (50.8" x 30.0" x 3.5")	1510.5mm x 886.5mm x 122mm (59.5" x 34.9" x 4.8")	1752.2mm x 1005.7mm x 110mm (69.0" x 39.6" x 4.3")	1510.5mm x 886.5mm x 122mm (59.5" x 34.9" x 4.8")	1752.2mm x 1005.7mm x 110mm (69.0" x 39.6" x 4.3")	1955.4mm x 1141.4mm x 98.8mm (77.0" x 44.9" x 3.9")
Net Weight	40.5 Kg (89.3 lbs)	55.3 Kg (121.9 lbs)	79 Kg (174.2 lbs)	55.3 Kg (121.9 lbs)	79 Kg (174.2 lbs)	95.1 Kg (209.7 lbs)
Packed Weight	58.1 Kg (128.1 lbs)	71.3 Kg (157.2 lbs)	102.5 Kg (226.0 lbs)	71.3 Kg (157.2 lbs)	102.5 Kg (226.0 lbs)	123.5 Kg (272.3 lbs)
Packed Dimensions	1530mm x 975mm x 260mm (60.2" x 38.3" x 10.2")	1765mm x 1165mm x 320mm (69.5" x 45.9" x 12.6")	1990mm x 1165mm x 320mm (78.3" x 45.9" x 12.6")	1765mm x 1165mm x 320mm (69.5" x 45.9" x 12.6")	1990mm x 1165mm x 320mm (78.3" x 45.9" x 12.6")	2200mm x 1490mm x 360mm (86.6" x 58.7" x 14.2")
Power Requirements	AC 100~240V	AC 100~240V	AC 100~240V	AC 100~240V	AC 100~240V	AC 100~240V
VESA Mount Point (Wall/Stand)	4 x M8 VESA 400mm x 400mm (15.7" x 15.7")	4 x M8 VESA 400mm x 400mm (15.7" x 15.7")	4 x M8 VESA 600mm x 600mm (23.6" x 23.6")	4 x M8 VESA 400mm x 400mm (15.7" x 15.7")	4 x M8 VESA 600mm x 600mm (23.6" x 23.6")	4 x M8 VESA 600mm x 400mm (23.6" x 15.7")
VESA Mount Point (NUC/Mini)	4 x M4 VESA 100mm x 75mm (3.9" x 3"), bracket not included	4 x M4 VESA 100mm x 75mm (3.9" x 3"), bracket not included	4 x M4 VESA 100mm x 75mm (3.9" x 3"), bracket not included	4 x M4 VESA 100mm x 75mm (3.9" x 3"), bracket not included	4 x M4 VESA 100mm x 75mm (3.9" x 3"), bracket not included	4 x M4 VESA 100mm x 75mm (3.9" x 3"), bracket not included

ACTIVPANEL HD 55" TECHNICAL DRAWING

FRONT

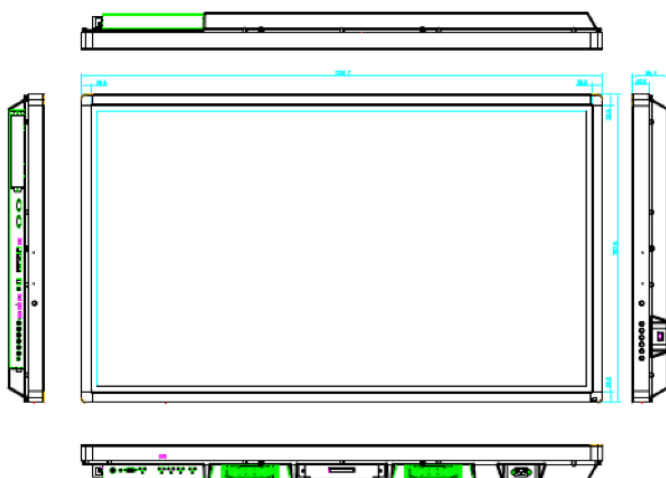

BACK

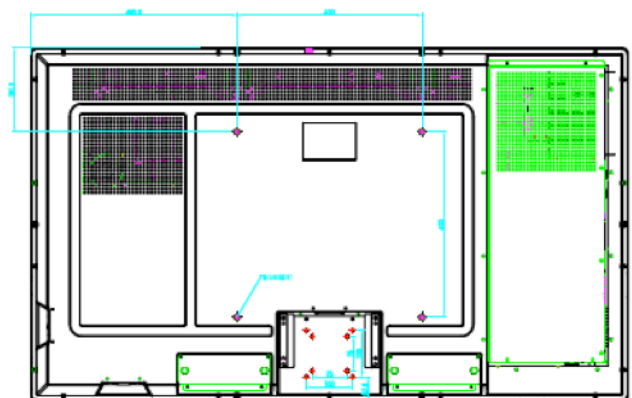

ACTIVPANEL HD 65" TECHNICAL DRAWING

FRONT

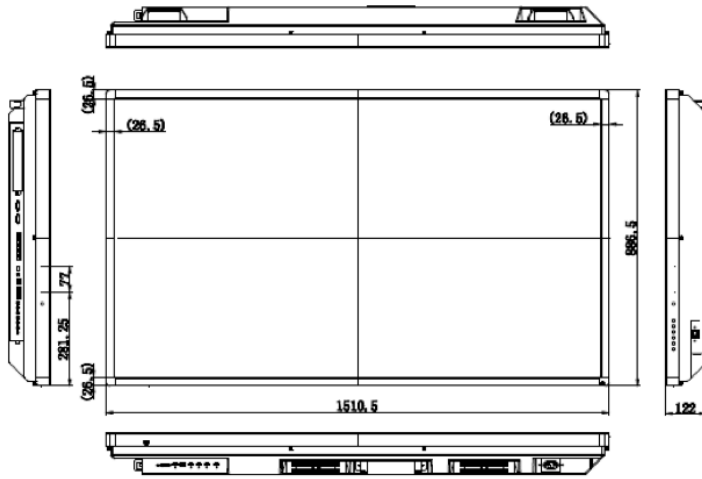

BACK

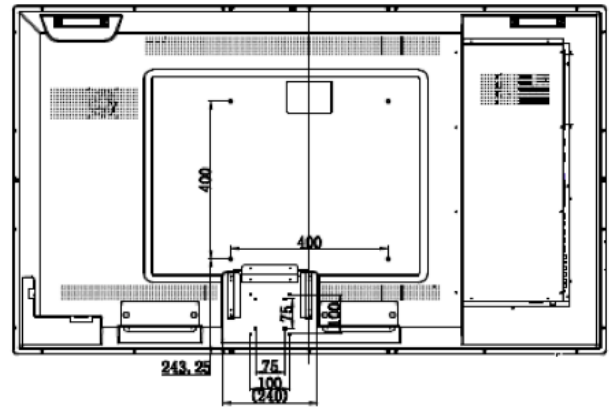

ACTIVPANEL HD 75" TECHNICAL DRAWING

FRONT

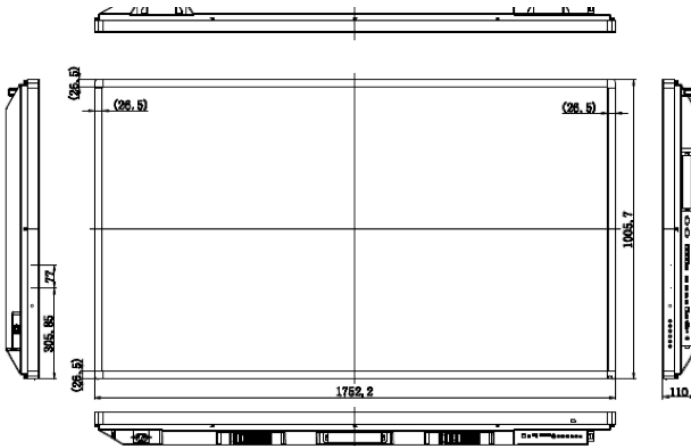

BACK

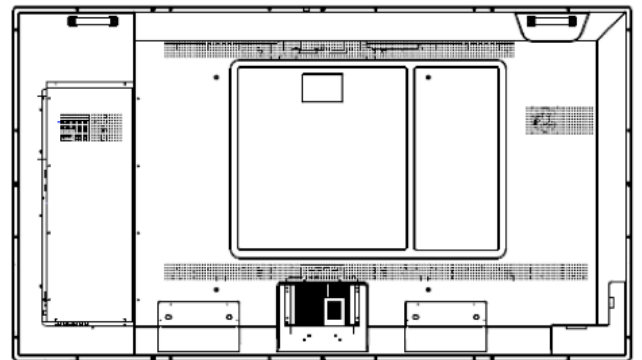

ACTIVPANEL 4k 84" TECHNICAL DRAWING

FRONT



BACK

